

**TRIVIEW METROPOLITAN DISTRICT WATER AND
WASTEWATER FEES/RATES
RESOLUTION
2024-04**

A RESOLUTION REGARDING THE ESTABLISHMENT OF RATES AND FEES FOR THE PROVISION OF WATER AND WASTEWATER SERVICES ALONG WITH ROAD AND BRIDGE FEES FOR SINGLE FAMILY AND MULTI FAMILY RESIDENTIAL CONSTRUCTION FOR THE TRIVIEW METROPOLITAN DISTRICT, EL PASO COUNTY, COLORADO.

WHEREAS, the Triview Metropolitan District (the "District") is a duly organized and existing special district operating under the provisions of the Special District Act, Section 32-1-101, *et seq.*, C.R.S.; and

WHEREAS, the District is governed by a Board of Directors (the "Board"), charged with the power to fix and from time to time increase fees, tolls, rates, and charges for services provided by the District to properties both within and without the District's boundaries; and

WHEREAS, the Board has determined that the rates currently charged for water and wastewater service to customers of the District are insufficient to defray the actual costs of such service, and that the District must establish such rates that cover the District's actual operating costs to remain economically viable; and

WHEREAS, the Board has determined that the Metering and Billing Charge, the Water and Wastewater Base Rate, Water and Wastewater Volume Rates, are currently insufficient to cover the Projected capital expenditures of the District and that the District must establish such rates fees that cover the District's projected Operating Expenditures, Capital Expenditures, including Debt Service payments; and

WHEREAS, this resolution was considered at a public meeting of the District following notice provided pursuant to Colorado Revised Statutes; and

WHEREAS, the District's provision of services to its constituents and customers confers a benefit, and the continued provision of such services is necessary to the health, safety, and wellbeing of its constituents and customers.

NOW, THEREFORE, BE IT RESOLVED that the Board of Directors of the District shall, and hereby does order that the rates and fees charged for water and wastewater services provided by the District, along with Road and Bridge fees, be established to an amount sufficient to offset the cost of service as reflected in the Attached Schedule which is hereby amended to reflect the rates in the attached Schedule hereto as adopted by this Resolution effective as of June 1, 2024.

RESOLVED this 23 day of May 2024.

TRIVIEW METROPOLITAN DISTRICT

(SEAL)



By: Mats Melin
Its: President

ATTEST:

[Signature]
SARA N. LAMB

2024 Residential Water and Wastewater Rates

2024 Rates

Water

Base Rate per month (Renewable Water Fee)	\$40.00
Metering and Billing Charge per month	\$5.00

Volume Rates per 1000 gallons

Tier 1	0 to 8,000	\$9.00
Tier 2	8,001 to 20,000	\$13.50
Tier 3	20,001 to 30,000	\$20.00
Tier 4	30,001 to 40,000	\$30.00
Tier 5	Over 40,000	\$40.00

Wastewater

Base rate per Month	\$57.68
Avg. Nov - Feb Volume Use Uniform Rate	\$5.69

Rates effective June 1, 2024.

2024 Irrigation Only Rates

Water

2024

Base Rate per month (Renewable Water Fee)

Meter Size

Base Rate	1-inch and less	\$80.00
Base Rate	1 1/2-inch	\$160.00
Base Rate	2-inch	\$320.00
Base Rate	3-inch	\$640.00

Metering and Billing Charge per month \$5.00

Volume Rates

Per 1,000 gallons

Uniform Rate \$10.25

Rates effective June 1, 2024.

2024 Commercial Water and Wastewater Rates

Water

2024

Base Rate per month (Renewable Water Fee)

Meter Size

Base Rate	1-inch and less	\$80.00
Base Rate	1 1/2-inch	\$160.00
Base Rate	2-inch	\$320.00
Base Rate	3-inch	\$640.00

Volume Rates

Per 1,000 gallons

Uniform Rate Water Charge per thousand gallons	\$10.25
Metering and Billing Charge per month	\$5.00

Wastewater

Base Rate per month

Meter Size

Base Rate	1-inch and less	\$115.36
Base Rate	1 1/2-inch	\$230.73
Base Rate	2-inch	\$461.45
Base Rate	3-inch	\$922.89

Volume Rates

Per 1,000 gallons

Uniform Wastewater Rate Based on Monthly Water useage	\$5.69
---	--------

Rates effective June 1, 2024

TRIVIEW METROPOLITAN DISTRICT TAP/IMPACT FEES SCHEDULE

RESIDENTIAL FEES

	WATER TAP FEE	SEWER TAP FEE	RENEWABLE WATER/TRANSMISSION FEE	DRAINAGE IMPACT FEE	PARK, REC & LANDSCAPE FEE	ROAD & BRIDGE FEE	Review and Comment Fee	SEWER IMPACT FEE	Water Meter Fee	1.25 Multiplier	Total
RESIDENTIAL:											
APARTMENT	\$6,020.00	\$5,500.00	\$7,201.00	\$687.50	\$1,686.50	\$2,000.00	\$500.00	\$500.00	\$750.00	\$0.00	\$24,845.00
ATTACHED SINGLE FAMILY	\$9,030.00	\$8,250.00	\$10,801.50	\$1,031.25	\$2,529.75	\$3,000.00	\$500.00	\$500.00	\$750.00	\$0.00	\$36,392.50
SINGLE FAMILY	\$12,040.00	\$11,000.00	\$14,402.00	\$1,375.00	\$3,373.00	\$4,000.00	\$500.00	\$500.00	\$750.00	\$0.00	\$47,940.00
DUPLEX	\$12,040.00	\$11,000.00	\$14,402.00	\$1,375.00	\$3,373.00	\$4,000.00	\$500.00	\$500.00	\$750.00	X 1.25	\$51,277.50

NOTE 1: Attached Single Family means Townhome or Condominiums.

Triview Metropolitan District requires that attached Single Family Units and Duplexes be supplied by individual meters.

Meter Kit change 10/24/2022 from \$500.00 to \$750.00

Effective June 1, 2024

**TRIVIEW METROPOLITAN DISTRICT TAP/IMPACT FEES SCHEDULE
CREEKSIDE DEVELOPMENT / JACKSON CREEK NORTH / RESIDENTIAL**

RESIDENTIAL:	WATER TAP FEE	SEWER TAP FEE	RENEWABLE WATER/TRANSMISSION FEE	DRAINAGE IMPACT FEE	PARK, REC & LANDSCAPE FEE	ROAD & BRIDGE FEE	Review and Commitment Fee	Water Meter Fee	Sewer Impact Fee	DEVELOPER ADMIN. FEE	1.25 Multiplier	Total
APARTMENT	\$6,020.00	\$5,500.00	\$7,201.00	\$687.50	\$1,686.50	\$2,000.00	\$500.00	\$750.00	\$500.00	\$750.00	\$0.00	\$25,595.00
ATTACHED SINGLE FAMILY	\$9,030.00	\$8,250.00	\$10,801.50	\$1,031.25	\$2,529.75	\$3,000.00	\$500.00	\$750.00	\$500.00	\$750.00	\$0.00	\$37,142.50
SINGLE FAMILY	\$12,040.00	\$11,000.00	\$14,402.00	\$1,375.00	\$3,373.00	\$4,000.00	\$500.00	\$750.00	\$500.00	\$1,500.00	\$0.00	\$49,440.00
Duplex	\$12,040.00	\$11,000.00	\$14,402.00	\$1,375.00	\$3,373.00	\$4,000.00	\$500.00	\$750.00	\$500.00	\$1,500.00	x 1.25	\$61,800.00

NOTE 1: Attached Single Family means Townhome or Condominiums.

Triview Metropolitan District requires that attached Single Family Units and Duplexes be supplied by individual meters

Meter Kit change from \$500.00 to \$750.00 on 10/24/2022

Effective Date June 1, 2024

TRIVIEW METROPOLITAN DISTRICT TAP/IMPACT FEES SCHEDULE
Home Place Ranch

RESIDENTIAL:	WATER TAP FEE	SEWER TAP FEE	RENEWABLE WATER/TRANSMISSION FEE	DRAINAGE IMPACT FEE	PARK, REC & LANDSCAPE FEE	ROAD & BRIDGE FEE	Review and Comment Fee	SEWER IMPACT FEE	Water Meter Fee	Western Interceptor Impact Fee	Total
APARTMENT	\$6,020.00	\$5,500.00	\$7,201.00	\$687.50	\$1,686.50	\$2,000.00	\$500.00	\$500.00	\$750.00	\$4,387.71	\$29,232.71
ATTACHED SINGLE FAMILY	\$9,030.00	\$8,250.00	\$10,801.50	\$1,031.25	\$2,529.75	\$3,000.00	\$500.00	\$500.00	\$750.00	\$4,387.71	\$40,780.21
SINGLE FAMILY	\$12,040.00	\$11,000.00	\$14,402.00	\$1,375.00	\$3,373.00	\$4,000.00	\$500.00	\$500.00	\$750.00	\$4,387.71	\$52,327.71

NOTE 1: Attached Single Family means Townhome or Condominiums.

Triview Metropolitan District requires that attached Single Family Units and Duplexes be supplied by individual meters.

Western Interceptor Impact Fee charge for first 153 Homes

Meter Kit change 10/24/2022 from \$500.00 to \$750.00

Effective June 1, 2024

**TRIVEW METROPOLITAN DISTRICT TAP/IMPACT FEES SCHEDULE
SANCTUARY POINTE RESIDENTIAL**

	WATER TAP FEE	SEWER TAP FEE	RENOVABLE WATER/TRANSMISSION FEE	DRAINAGE IMPACT FEE	PARK, REC & UNBOC FEE	ROAD & BRIDGE FEE	Review and Commute Fee	SEWER IMPACT FEE	Water Meter Fee	WATER IMPACT FEE	Total	IN LIEU OF FEES	Total
RESIDENTIAL:													
APARTMENT	\$6,020.00	\$5,500.00	\$7,201.00	\$687.50	\$1,686.50	\$2,000.00	\$500.00	\$500.00	\$750.00	\$3,000.00	\$27,845.00		\$27,845.00
PATIO HOMES	\$12,040.00	\$11,000.00	\$14,402.00	\$1,375.00	\$3,373.00	\$3,000.00	\$500.00	\$500.00	\$750.00		\$2,094.75		\$49,034.75
ATTACHED SINGLE FAMILY	\$9,030.00	\$9,250.00	\$10,801.50	\$1,031.25	\$2,529.75	\$3,000.00	\$500.00	\$500.00	\$750.00	\$3,000.00	\$39,392.50		\$39,392.50
SINGLE FAMILY	\$12,040.00	\$11,000.00	\$14,402.00	\$1,375.00	\$3,373.00	\$4,000.00	\$500.00	\$500.00	\$750.00	\$3,000.00	\$50,940.00		\$50,940.00
										Fee only on BLUE section of Map Below		IN LIEU OF FEES Fee only on Yellow section of map BELOW	\$2,793.00
													\$38,538.00

NOTE 1: Attached Single Family means Townhome or Condominiums with individual meters.
Triflow Metropolitan District requires that attached Single Family Units and Duplexes be supplied by individual meters.

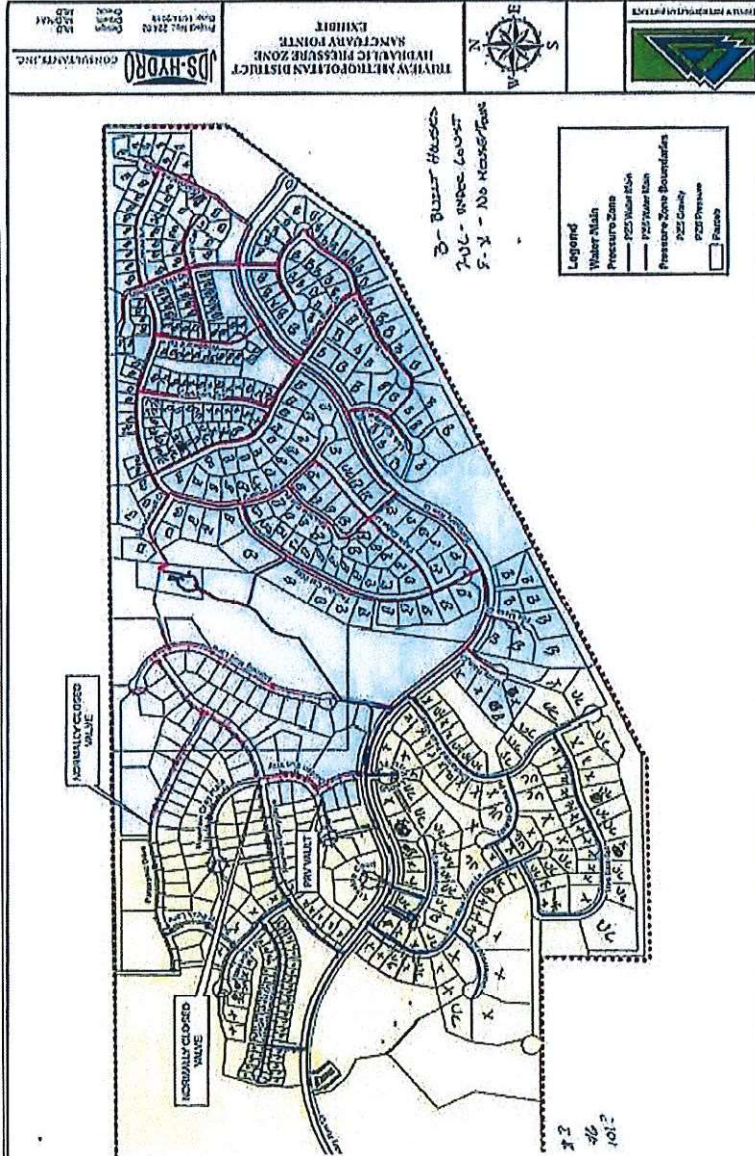

Effective January 1, 2022.
Terminology change on Renewable Water description Oct. 23, 2019
WATER IMPACT FEE SECTION BLUE ON MAP
IN LIEU OF FEES SECTION YELLOW ON MAP, Patio Homes (Sage Forest) = \$2,094.75
Single Family in Section Yellow = \$2,793.00
Meter fee change from \$500.00 to \$750.00 on 10/24/2022

